

Technical data

KILIG
9



6970x2340 mm



6



4



2



1150 x 650

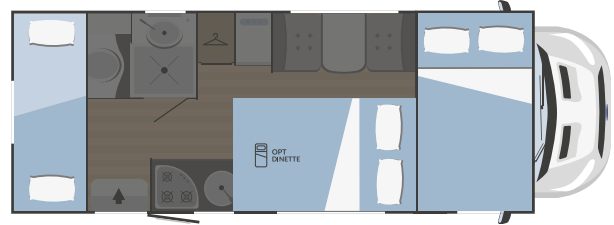
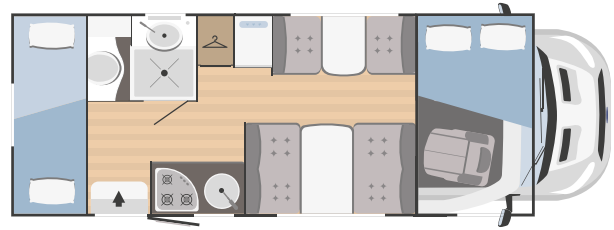

MECHANICAL UNIT

Engine	Ford Transit
Wheelbase (mm)	3750
Displacement (L)	2,0
Maximum power (kW-HP)	96 - 130
Radio MP3	✓

DIMENSIONS AND WEIGHTS

Outside length (mm)	6970
Outside width - inside width (mm)	2340 - 2200
Maximum outside height - inside height (mm)	3040 - 2060
Thickness of floor - walls - roof (mm)	56 - 30 - 30
Certified seats	6
Maximum overall weight (kg)	3500

BEDS

Berths	4
Assemblable berths (opt)	2
Overcab double bed	1430x2200
Centre dinette single bed	-
Centre dinette double bed	1290x1890
Front drop-down bed	-
Rear single bed	-
Rear double bed	-
Bunk bed	800x2200
Rear drop-down double bed	-

TANKS

Drinking water (inside)	20 + 65 l.
Waste water tank	120 l.
Antifreeze tank	on request

EQUIPMENT

Cabin swivel seats	✓
Panoramic porthole living area	on request
Openable panoramic porthole low-profile models front pod	-
Gas heater	Combi C4
Water heater	Combi C4
Gas bottle locker	(1+1) x 11:13 kg
Fridge	141 l.
Extractor hood	on request
Nr. burners hob	3
Oven	on request
Garage (access door dimensions)	1150 x 650
H (mm) x W (mm)	
Driver's cabin blackout blind	on request
Entrance door with fly screen	on request
TV-holder	on request
Roof rack with ladder	on request
Service battery	on request
Cabin seat covers	on request
Parking feet	on request
Bicycle rack	on request
Alarm system	on request
Outside entrance door lamp	on request
Tow bar	-

*the Ford Transit 114 kW - 155 CV engine is available on request