

Technical data

KILIG
69 PLUS



7308x2340 mm



5



4



1



750 x 850
(1150 x 850
on request)

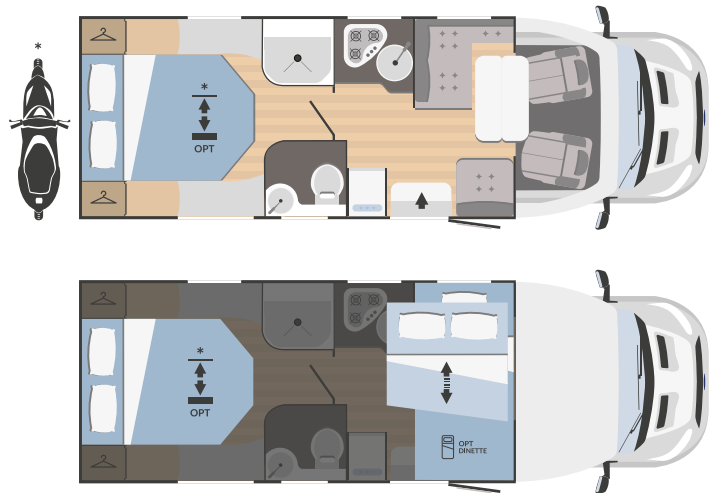

MECHANICAL UNIT

Engine	Ford Transit
Wheelbase (mm)	3954
Displacement (L)	2,0
Maximum power (kW-HP)	96 - 130 *
Radio MP3	✓

DIMENSIONS AND WEIGHTS

Outside length (mm)	7308
Outside width - inside width (mm)	2340 - 2200
Maximum outside height - inside height (mm)	2845 - 2060
Thickness of floor - walls - roof (mm)	56 - 30 - 30
Certified seats	5
Maximum overall weight (kg)	3500

BEDS

Berths	4
Assemblable berths (opt)	1
Overcab double bed	-
Centre dinette single bed	1040 X 2200
Centre dinette double bed	-
Front drop-down bed	1215 x 2000
Rear single bed	-
Rear double bed	1400 x 1900
Bunk bed	-
Rear drop-down double bed	on request

TANKS

Drinking water (inside)	20 + 65 l.
Waste water tank	120 l.
Antifreeze tank	on request

EQUIPMENT

Cabin swivel seats	✓
Panoramic porthole living area	-
Openable panoramic porthole low-profile models front pod	on request
Gas heater	Combi C4
Water heater	Combi C4
Gas bottle locker	(1+1) x 11:13 kg
Fridge	141 l.
Extractor hood	on request
Nr. burners hob	3
Oven	on request
Garage (access door dimensions) H (mm) x W (mm)	750 x 850 (1150 x 850 on request)
Driver's cabin blackout blind	on request
Entrance door with fly screen	on request
TV-holder	on request
Roof rack with ladder	on request
Service battery	on request
Cabin seat covers	on request
Parking feet	on request
Bicycle rack	on request
Alarm system	on request
Outside entrance door lamp	on request
Tow bar	-

*the Ford Transit 114 kW - 155 CV and 125 kW - 170 CV engine is available on request